

Pro 550 SP 2st Chassis Assembly 1981/87

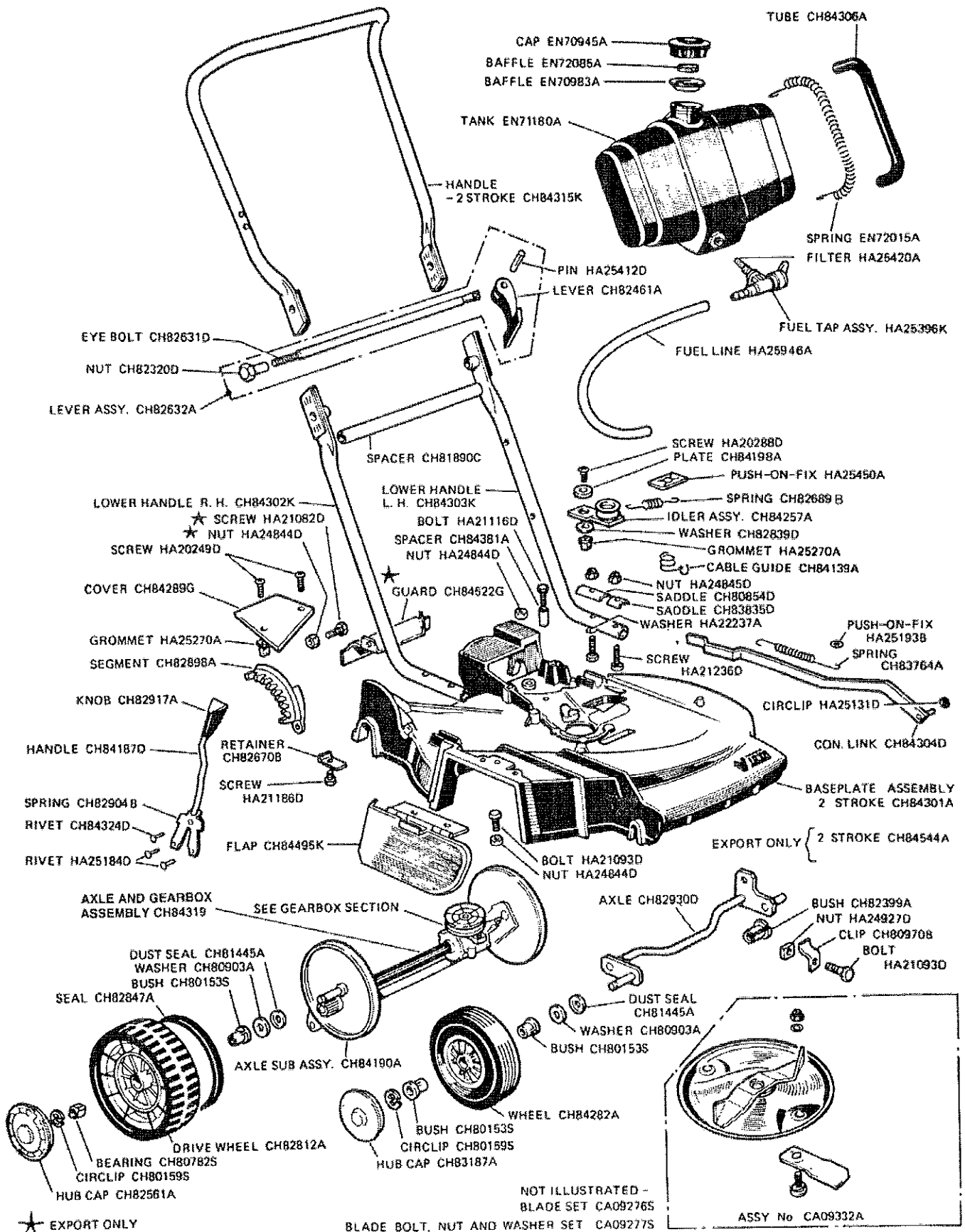

★ EXPORT ONLY

NOT ILLUSTRATED -
BLADE SET CA09276S
BLADE BOLT, NUT AND WASHER SET CA09277S

ASSY No CA09332A

Pro 550 SP 2st Gearbox Assembly 1981/87

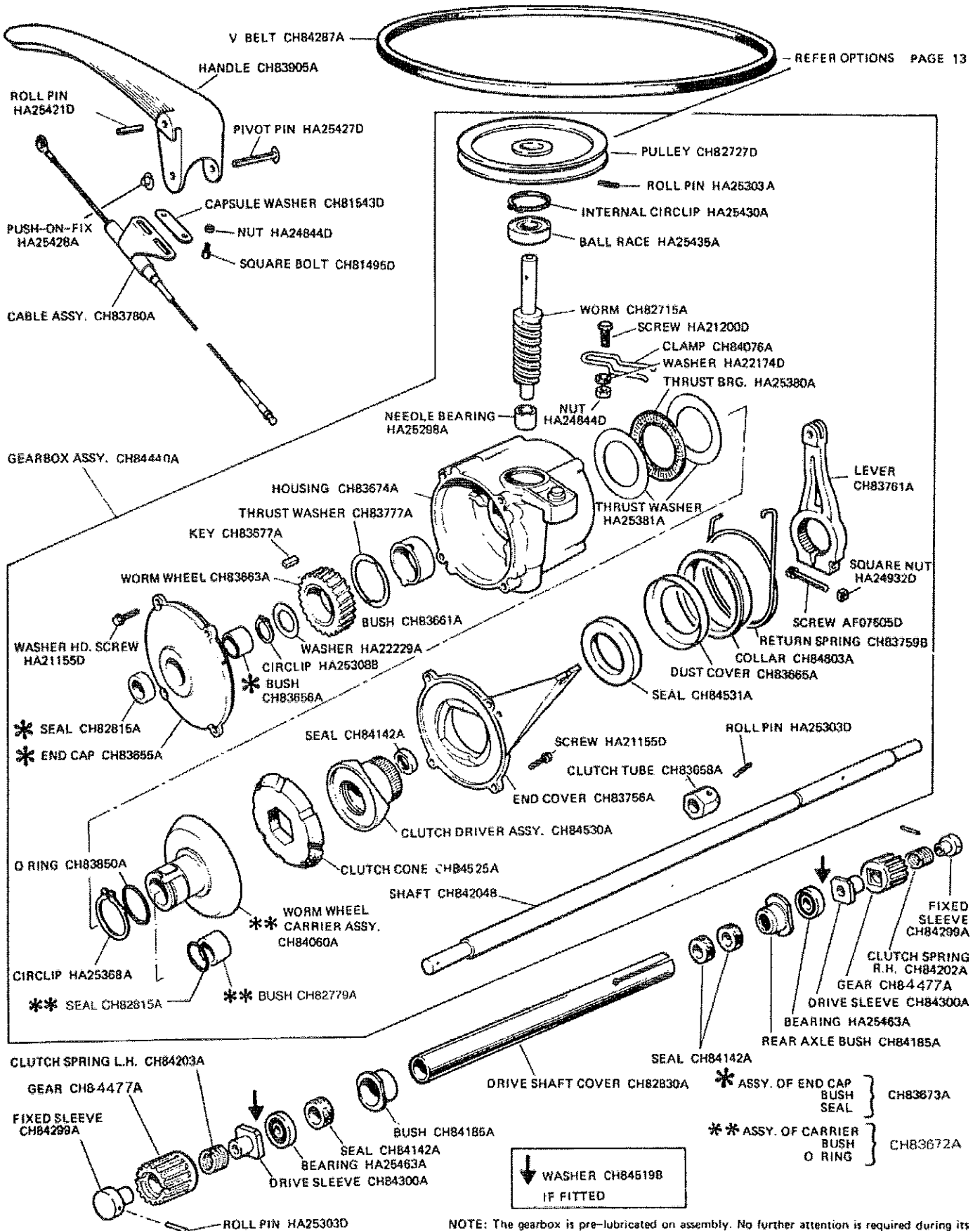

NOTE: The gearbox is pre-lubricated on assembly. No further attention is required during its working life. After major service, repack with "B.P. Energrease AO" or an equivalent grease.

DRIVE SHAFT & GEARBOX ASSEMBLY

